

Framing of floor: All lumber is nominal 2x6. (This may have to be increased to 2 x 8 for heavier loads or long spans).

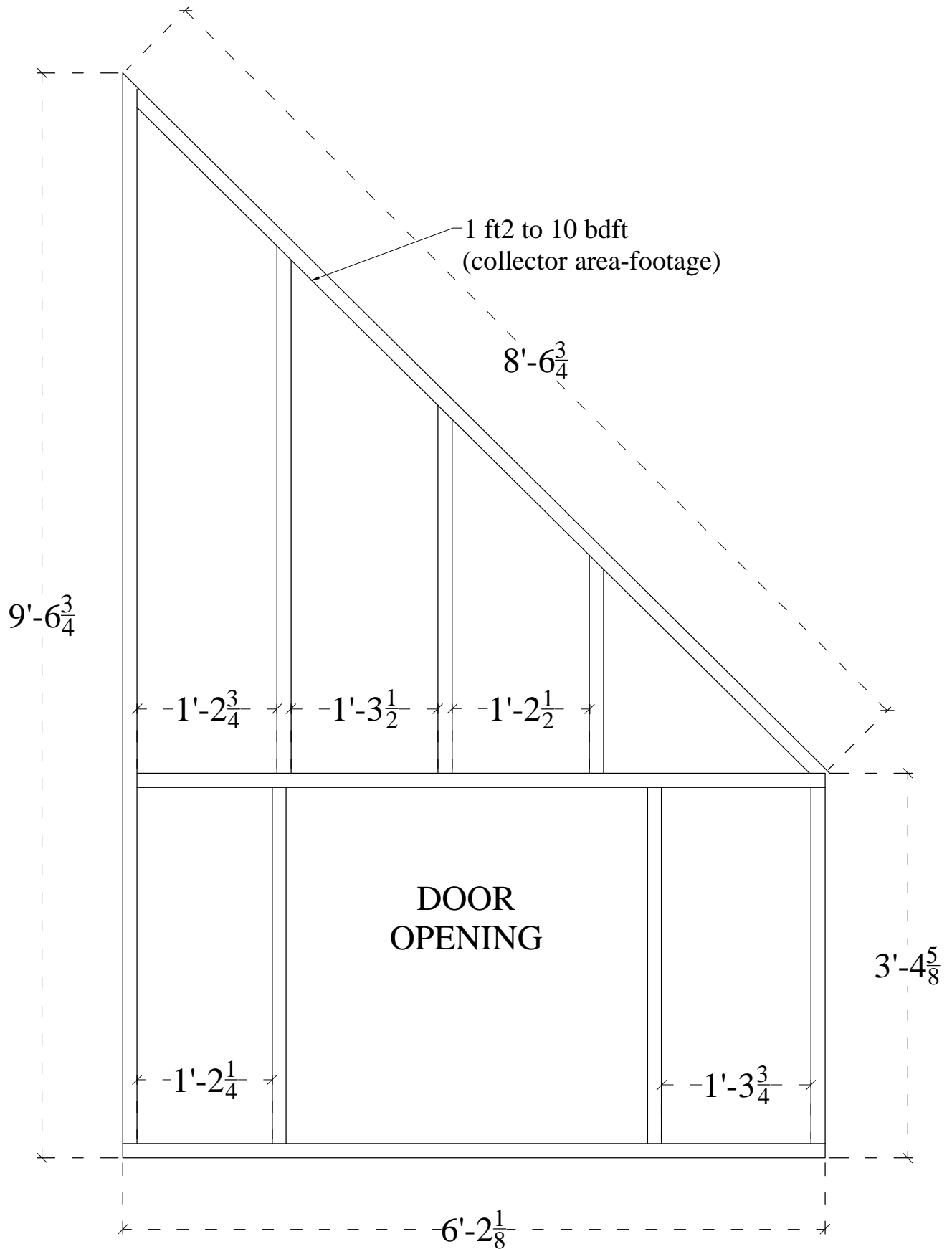

Framing of east and west walls.  
 All lumber is nominal 2 x 4.

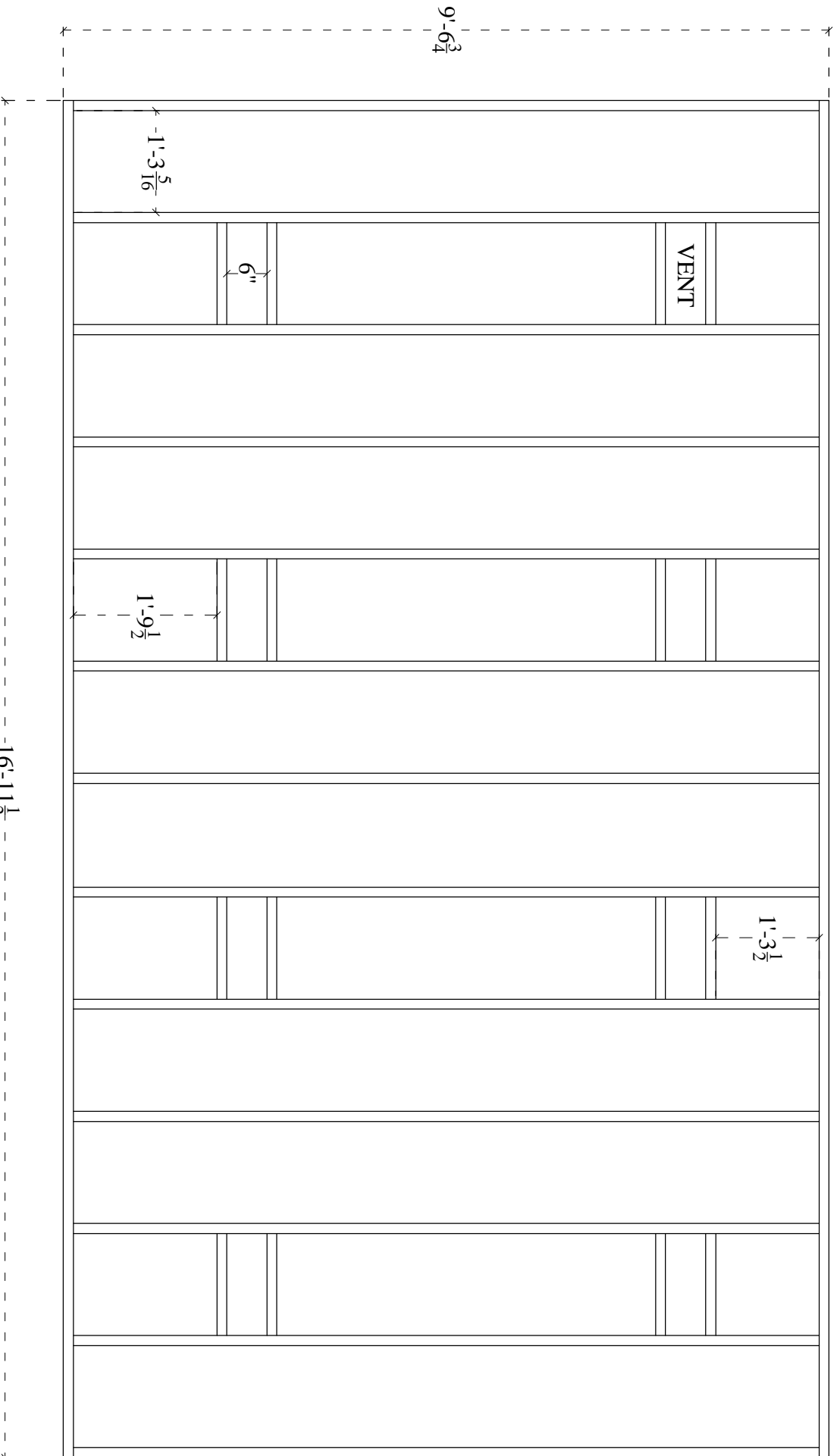

Framing of north wall. All lumber is nominal 2 x 4.

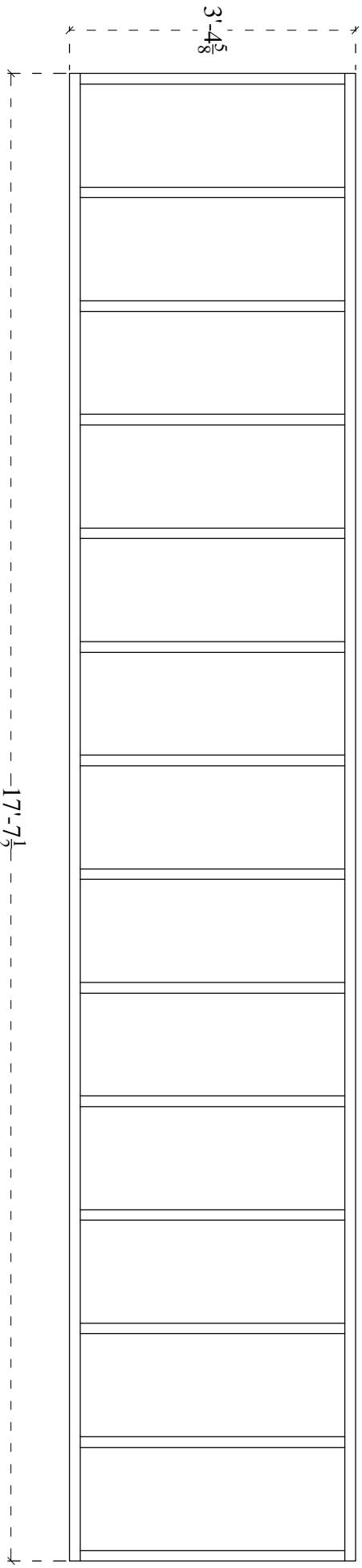

Framing of south wall. All lumber is nominal 2 x 4.

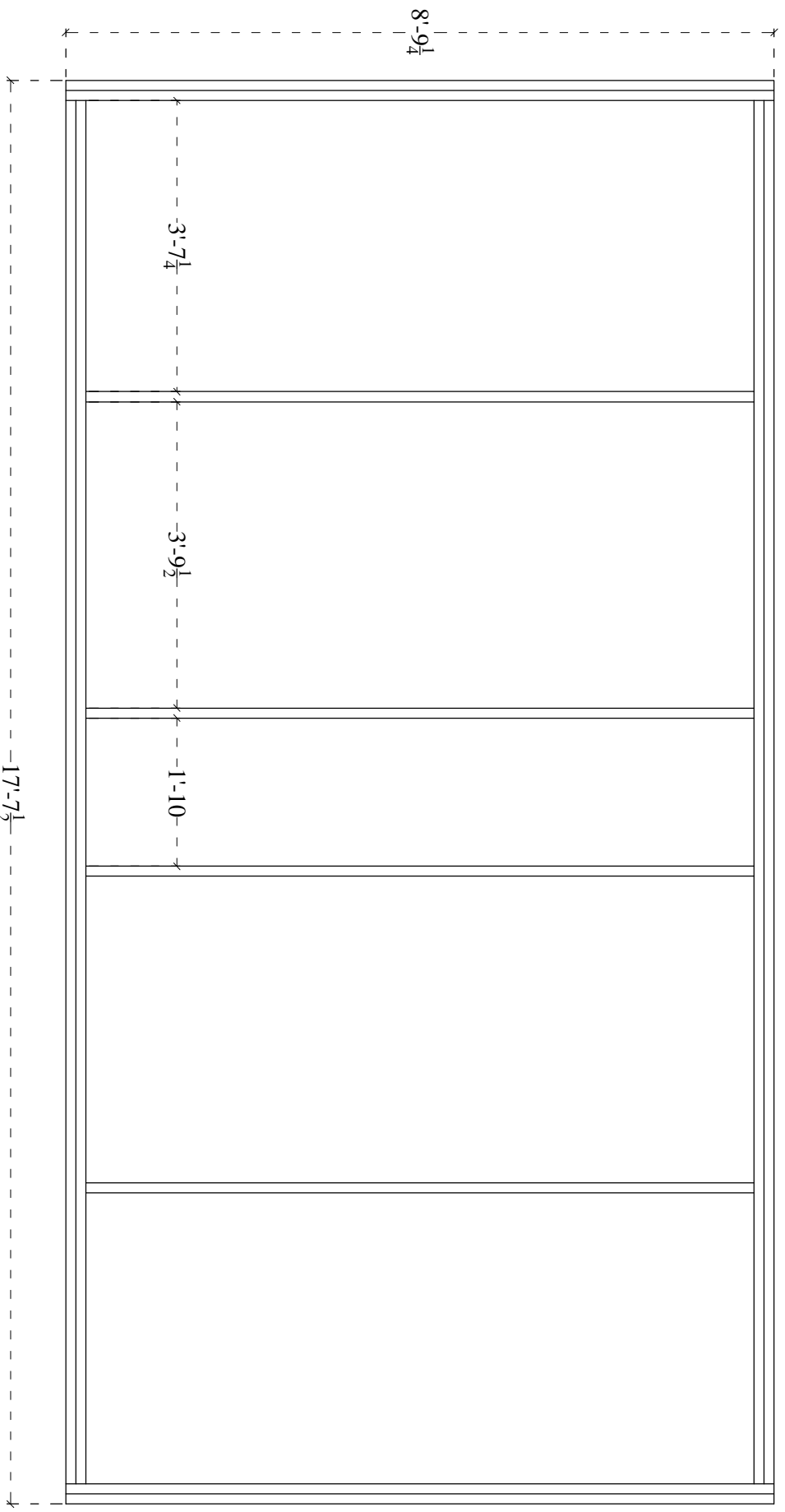
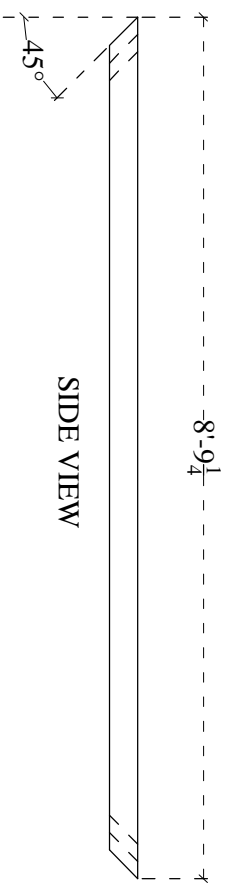

Framing of roof. Spacing may be altered to accommodate width of covering material or heavy snow loads. All lumber is nominal 2 x 4.