

# Tallwood Design Institute Fellowships at Oregon State University

Fall 2019

Dr. Arijit Sinha, Dr. Andre R. Barbosa, and Dr. Barbara Simpson

mass timber rocking wall  
system for resiliency and  
sustainability

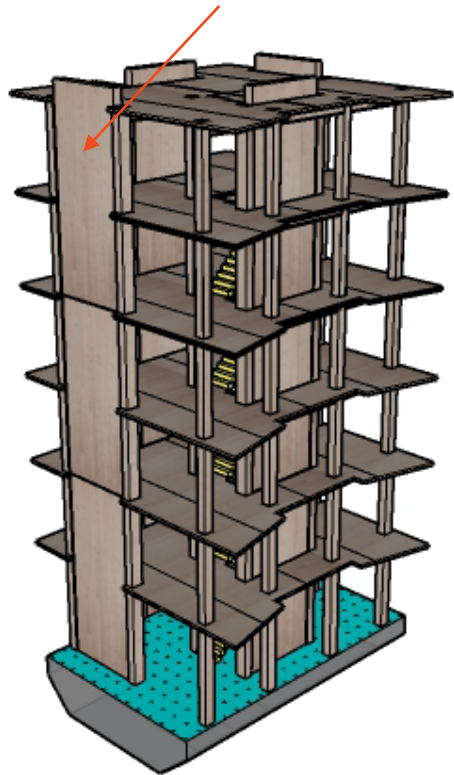

Multiple faculty members are seeking M.S. and Ph.D. level graduate assistants to join their collaborative research teams. M.S.-level position typically lasts **24 months**, while average Ph.D.-level position last **3 years**.

The anticipated scope of work incorporates full-scale experiments of a 3-story building with different mass-timber seismic force-resisting systems, including and high-fidelity numerical simulations. The graduate student researchers will also play an important role in an upcoming mass-timber building experiment at the University of California, San Diego shake table, the largest shake table in the U.S, in collaboration with the NHERI TallWood research team led by Dr. Shiling Pei.

The appointment is expected to be filled as soon as possible with an anticipated latest start date of **Sept. 25, 2019**. This fellowship includes a **monthly stipend and covered tuition, health insurance, and student fees**.

The graduate assistants will be working on research projects supported by the Tallwood Design Institute (TDI). Opportunities to seek dual major degrees within College of Engineering and College of Wood Science exist. Candidates should have a B.S. degree in Civil Engineering with a focus on Structural Engineering or Wood Science.

**To Apply:** Please contact Prof. Barbara Simpson by email at [barbara.simpson@oregonstate.edu](mailto:barbara.simpson@oregonstate.edu) with the subject heading "Tallwood Fellowship Application" and provide a CV and the contact information of at least two references. Review of applications will begin immediately but is expected to **close by August 1**. Additional supporting information may be requested upon review.

**Additional Information:** Additional details about the Tallwood Design Institute with which the Follow will be affiliated can be found at: <http://tallwoodinstitute.org/>. Information on the Civil and Construction Department and Forestry department can be found at <https://cce.oregonstate.edu/> and <https://www.forestry.oregonstate.edu/>.

Oregon State University is in Corvallis, OR located 45 minutes from the Oregon coast and the Cascade mountain range and 1.5 hours south of Portland, OR.



**Oregon State  
University**

**TALLWOOD**  
DESIGN INSTITUTE